

- Legend:**
- City Boundary
 - Proposed Development Boundary
 - Proposed Road Geometry
 - Earthworks - Fill
 - Earthworks - Cut
 - Proposed Carriageway Pavement
 - Proposed Grass Verge
 - Proposed Cycleway
 - Proposed Footpath
 - Proposed Shared Footpath/Cycleway
 - Proposed Traffic Island
 - Structure (S)
 - Proposed Retaining wall (R)
 - Proposed Mammal Underpass (C)
 - Proposed Culvert (C)
 - Proposed Attenuation Pond / Infiltration Basin / Wetlands
 - Proposed Stream Diversion
 - AR - Access Road
 - WC - Watercourse

San áiríúmh tá sonraíocht Shuirbhéireacht Orlándaís Éireann arna áitirgeadh fíor Cheadúnas OSI Uimh. 2010/18CCMA/Comhairle Contae na Gaillimhe. Sárúinn áitirgeadh neamhdáraithe cóipeacht Shuirbhéireacht Orlándaís Éireann agus Rialtas na hÉireann. © Suirbhéireacht Orlándaís Éireann, 2010.

© Suirbhéireacht Orlándaís Éireann. Gach ceart ar chosaint. Uimhir cheadúnais 2010/18CCMA/Comhairle Contae na Gaillimhe.

Includes Ordnance Survey Ireland data reproduced under OSI Licence number 2010/18CCMA/Galway County Council. Unauthorised reproduction infringes Ordnance Survey Ireland and Government of Ireland copyright. © Ordnance Survey Ireland, 2010.

© Ordnance Survey Ireland. All rights reserved. Licence number 2010/18CCMA/Galway County Council.

Clients

Comhairle Chontae na Gaillimhe
Galway County Council

N6
Galway City Transport Project

An Roinn Iompair
Turasóireacht agus Spóirt
Department of Transport, Tourism and Sport

TIIP
Transport Infrastructure Ireland

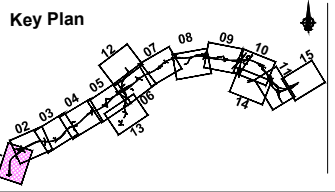

Consultant

ARUP

Corporate House
City East Business Park
Ballybrit, Galway, Ireland.

Tel +353 (0)91 460675
www.N6GalwayCity.ie
www.arup.ie

Job Title
N6 Galway City Ring Road

Scale
1:5000 @ A3

Date:
September 2018

Issue	Date	By	Chkd	Appd
11	28/09/2018	KJ	MH	EMC

Drawing Title
Proposed Road Development Plan
CH.0+000 to CH.1+350
Sheet 1 of 15

Drawing Status
For Information

Job No 233985	Drawing No Figure 5.1.01	Issue 11
-------------------------	------------------------------------	--------------------

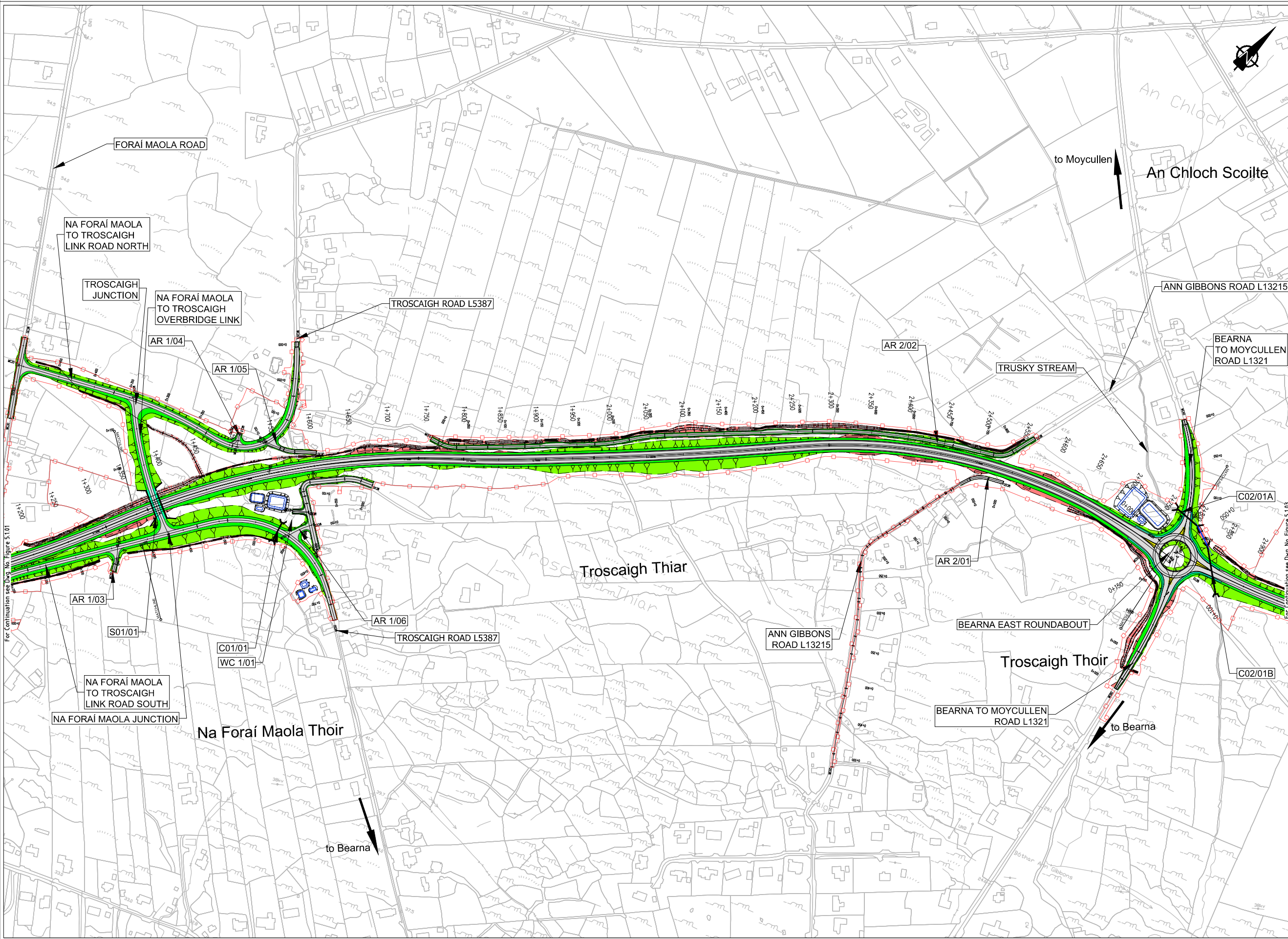

- Legend:**
- City Boundary
 - Proposed Development Boundary
 - Proposed Road Geometry
 - Earthworks - Fill
 - Earthworks - Cut
 - Proposed Carriageway Pavement
 - Proposed Grass Verge
 - Proposed Cycleway
 - Proposed Footpath
 - Proposed Shared Footpath/Cycleway
 - Proposed Traffic Island
 - Structure (S)
 - Proposed Retaining wall (R)
 - Proposed Mammal Underpass (C)
 - Proposed Culvert (C)
 - Proposed Attenuation Pond / Infiltration Basin / Wetlands
 - Proposed Stream Diversion
 - AR - Access Road
 - WC - Watercourse

Son áireamh tá sonraíochtaí Shairbhéireachtaí Orlándaís Éireann arna aistriú go dtí fíor Chuidiní OSI Uimh. 2010/18CCMA/Comhairle Contae na Gaillimhe. Sáráilom aistriú go dtí na h-áireamh na h-Éireann. © Sairbhéireachtaí Orlándaís Éireann, 2010.

© Sairbhéireachtaí Orlándaís Éireann. Gach ceart ar chosaint. Uimhir cheadainí 2010/18CCMA/Comhairle Contae na Gaillimhe.

Includes Ordnance Survey Ireland data reproduced under OSI Licence number 2010/18CCMA/Galway County Council. Unauthorised reproduction infringes Ordnance Survey Ireland and Government of Ireland copyright. © Ordnance Survey Ireland, 2010.

© Ordnance Survey Ireland. All rights reserved. Licence number 2010/18CCMA/Galway County Council.

Clients

Comhairle Chontae na Gaillimhe
Galway County Council

Galway City Transport Project

An Roinn Iompair
Turasóireachta agus Spóirt
Department of Transport, Tourism and Sport

TII
Transport Infrastructure Ireland

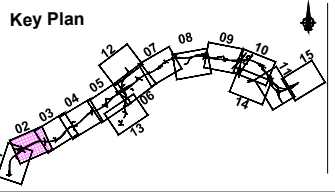

Consultant

ARUP

Corporate House
City East Business Park
Ballybrit, Galway, Ireland.

Tel +353 (0)91 460675
www.NGalwayCity.ie
www.arup.ie

Job Title
N6 Galway City Ring Road

Scale
1:5000 @ A3

Date:
September 2018

Issue	Date	By	Chkd	Appd
11	28/09/2018	KJ	MH	EMC

Drawing Title
Proposed Road Development Plan
CH.14-350 to CH.2+799
Sheet 2 of 15

Drawing Status
For Information

Job No
233985

Drawing No
Figure 5.1.02

Issue
11

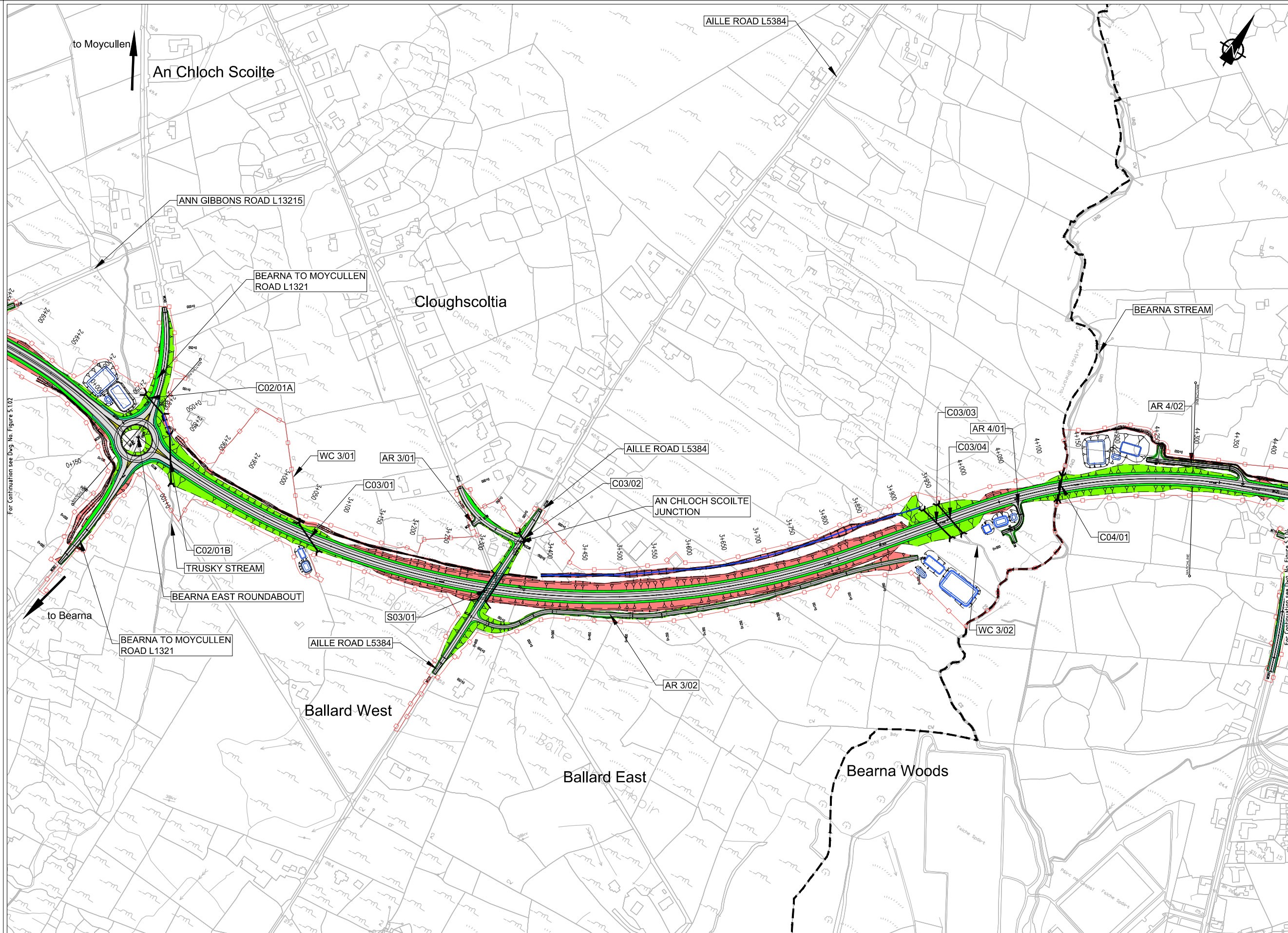

- Legend:**
- City Boundary
 - Proposed Development Boundary
 - Proposed Road Geometry
 - Earthworks - Fill
 - Earthworks - Cut
 - Proposed Carriageway Pavement
 - Proposed Grass Verge
 - Proposed Cycleway
 - Proposed Footpath
 - Proposed Shared Footpath/Cycleway
 - Proposed Traffic Island
 - Structure (S)
 - Proposed Retaining wall (R)
 - Proposed Mammal Underpass (C)
 - Proposed Culvert (C)
 - Proposed Attenuation Pond / Infiltration Basin / Wetlands
 - Proposed Stream Diversion
 - AR - Access Road
 - WC - Watercourse

Son áiríamh tá sonraíocht Shairbhíreacht Orlándaís Éireann arna aistriú go dtí físeán OSI Uimh. 2010/18CCMA/Comhairle Contae na Gaillimhe. Sáráilom aistriú go dtí na h-áiríamh na h-Éireann. © Sairbhíreacht Orlándaís Éireann, 2010.

© Sairbhíreacht Orlándaís Éireann. Gach ceart ar chosaint. Uimhir cheadainis 2010/18CCMA/Comhairle Contae na Gaillimhe.

Includes Ordnance Survey Ireland data reproduced under OSI Licence number 2010/18CCMA/Galway County Council. Unauthorised reproduction infringes Ordnance Survey Ireland and Government of Ireland copyright. © Ordnance Survey Ireland, 2010.

© Ordnance Survey Ireland. All rights reserved. Licence number 2010/18CCMA/Galway County Council.

Clients

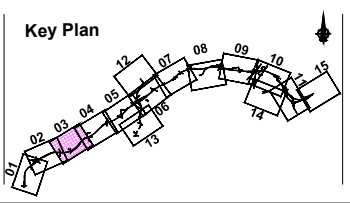

Consultant

Corporate House
City East Business Park
Ballybrit, Galway, Ireland.

Tel +353 (0)91 460675
www.N6GalwayCity.ie
www.arup.ie

Job Title
N6 Galway City Ring Road

Scale
1:5000 @ A3

Date:
September 2018

Issue	Date	By	Chkd	Appd
11	28/09/2018	KJ	MH	EMC

Drawing Title
Proposed Road Development Plan
CH.2+799 to CH.4+300
Sheet 3 of 15

Drawing Status
For Information

Job No
233985

Drawing No
Figure 5.1.03

Issue
11

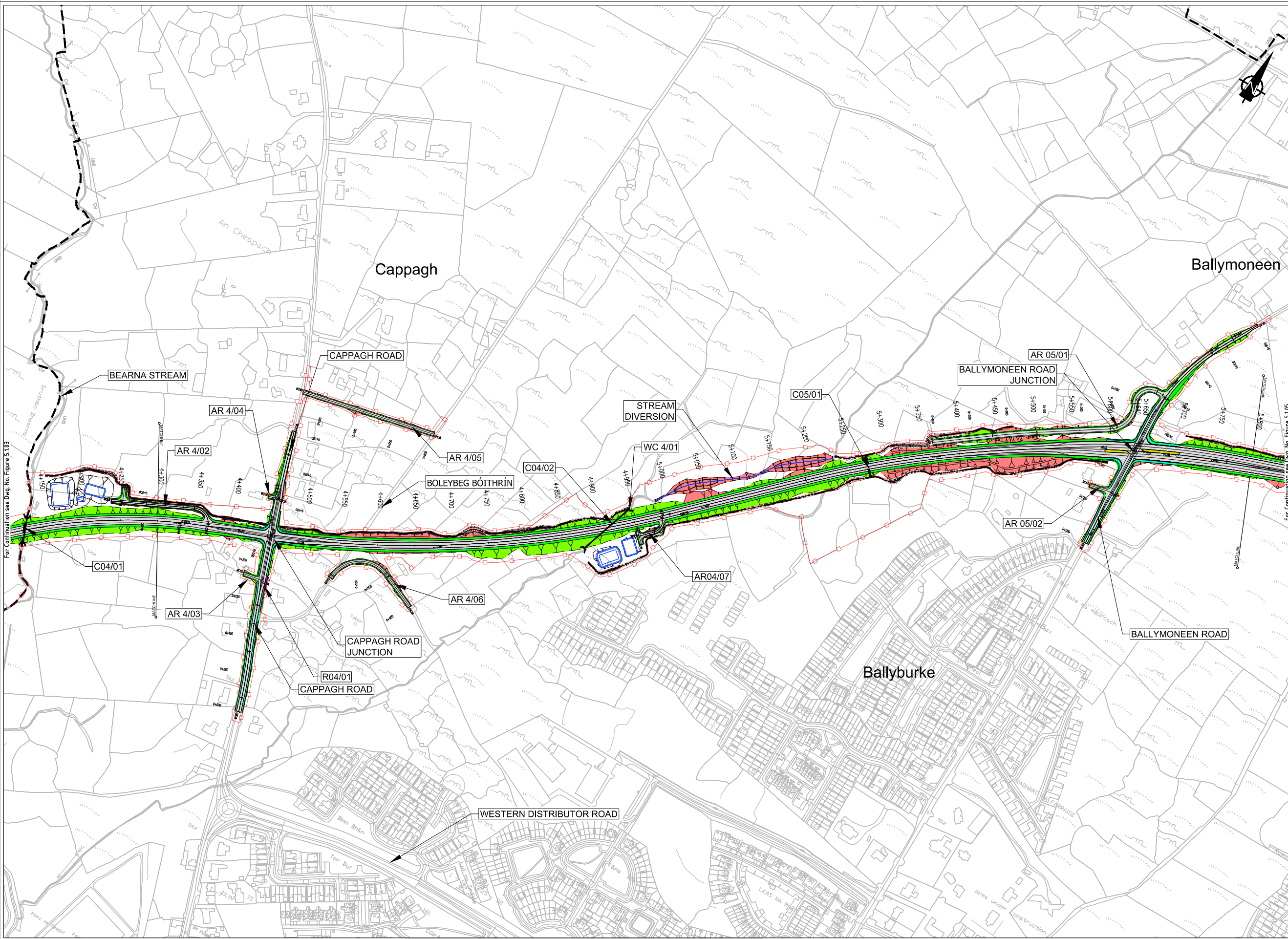

- Legend:**
- City Boundary
 - - - Proposed Development Boundary
 - ▬▬▬ Proposed Road Geometry
 - ▬▬▬ Earthworks - Fill
 - ▬▬▬ Earthworks - Cut
 - ▬▬▬ Proposed Carriageway Pavement
 - ▬▬▬ Proposed Grass Verge
 - ▬▬▬ Proposed Cycleway
 - ▬▬▬ Proposed Footpath
 - ▬▬▬ Proposed Shared Footpath/Cycleway
 - ▬▬▬ Proposed Traffic Island
 - ▬▬▬ Structure (S)
 - ▬▬▬ Proposed Retaining wall (R)
 - ▬▬▬ Proposed Mammal Underpass (C)
 - ▬▬▬ Proposed Culvert (C)
 - ▬▬▬ Proposed Attenuation Pond / Infiltration Basin / Wetlands
 - ▬▬▬ Proposed Stream Diversion
 - AR - Access Road
 - WC - Watercourse

For Continuation see Fig. No. Figure 5.103

For Continuation see Fig. No. Figure 5.105

Son áiríamh tá sonraíocht Shairbhíreacht Orlándaí Éireann arna aistriú go dtí Ceardúnas OSI Uimh. 2010/18CCMA/Comhairle Contae na Gaillimhe. Sáráilom aistriú go dtí na mbeirteanna na císcheart Shairbhíreacht Orlándaí Éireann agus Rialtas na hÉireann. © Sairbhíreacht Orlándaí Éireann, 2010.

© Sairbhíreacht Orlándaí Éireann. Gach ceart ar chosaint. Uimhir cheadúnais 2010/18CCMA/Comhairle Contae na Gaillimhe.

Includes Ordnance Survey Ireland data reproduced under OSI Licence number 2010/18CCMA/Galway County Council. Unauthorised reproduction infringes Ordnance Survey Ireland and Government of Ireland copyright. © Ordnance Survey Ireland, 2010.

© Ordnance Survey Ireland. All rights reserved. Licence number 2010/18CCMA/Galway County Council.

Clients

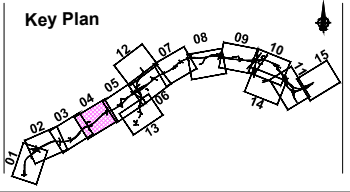

Consultant

Corporate House
City East Business Park
Ballybrit, Galway, Ireland.

Tel +353 (0)91 460675
www.N6GalwayCity.ie
www.arup.ie

Job Title
N6 Galway City Ring Road

Scale
1:5000 @ A3

Date:
September 2018

Issue	Date	By	Chkd	Appd
11	28/09/2018	KJ	MH	EMC

Drawing Title
**Proposed Road Development Plan
CH.4+300 to CH.5+800
Sheet 4 of 15**

Drawing Status
For Information

Job No
233985

Drawing No
Figure 5.1.04

Issue
11

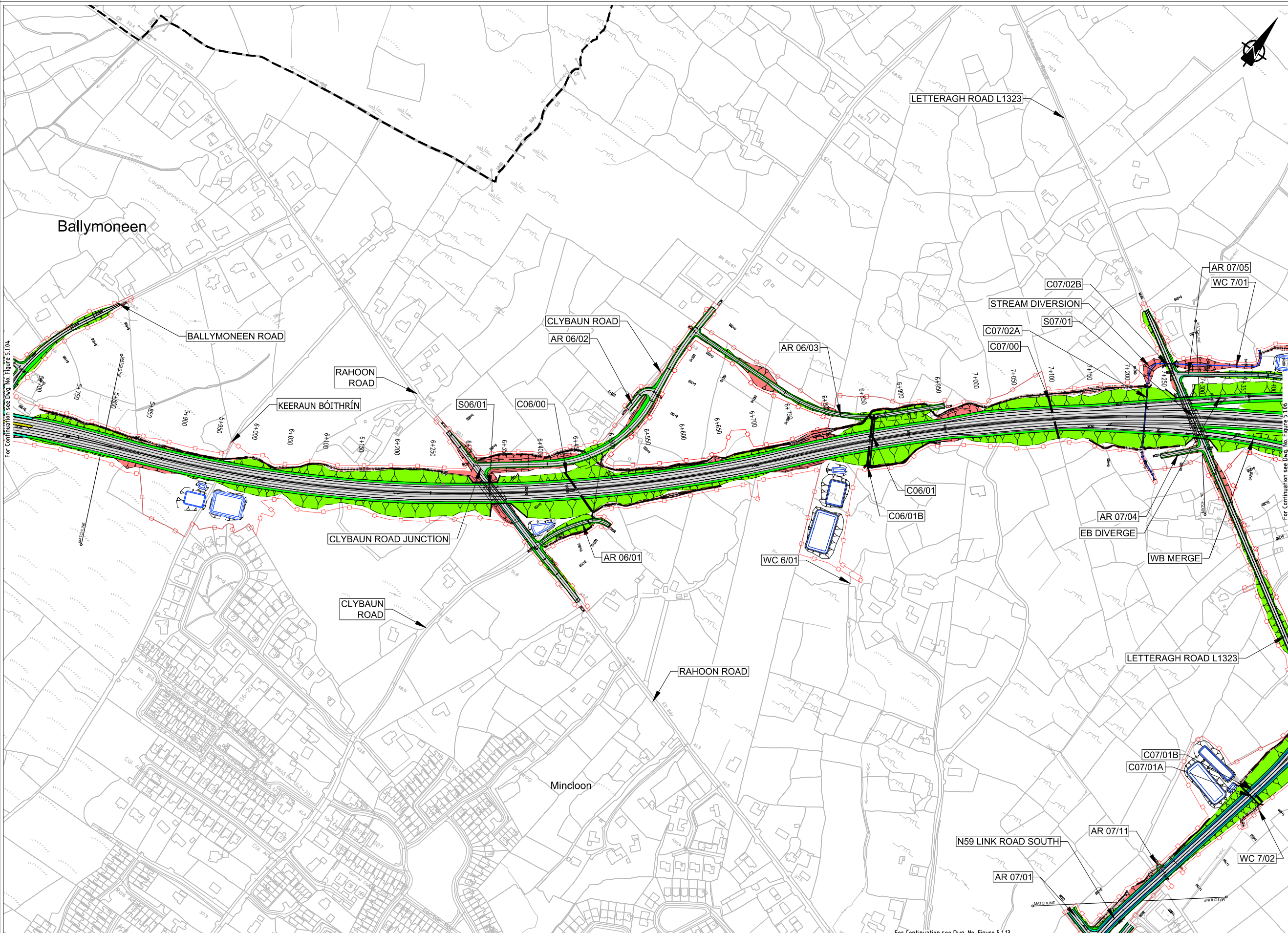

- Legend:**
- City Boundary
 - Proposed Development Boundary
 - Proposed Road Geometry
 - Earthworks - Fill
 - Earthworks - Cut
 - Proposed Carriageway Pavement
 - Proposed Grass Verge
 - Proposed Cycleway
 - Proposed Footpath
 - Proposed Shared Footpath/Cycleway
 - Proposed Traffic Island
 - Structure (S)
 - Proposed Retaining wall (R)
 - Proposed Mammal Underpass (C)
 - Proposed Culvert (C)
 - Proposed Attenuation Pond / Infiltration Basin / Wetlands
 - Proposed Stream Diversion
 - AR - Access Road
 - WC - Watercourse

Sun áiríonn sé sonraíocht Shairbhéiríochtaí Orlándaí Éireann arna aistriú go dtailíú físeánúcháin OSI Uimh. 2010/18CCMA/Comhairle Contae na Gaillimhe. Sáráilonn aistriú go dtailíú na n-áiríochtaí cíoschearta Shairbhéiríochtaí Orlándaí Éireann agus Rialtas na hÉireann. © Sairbhéiríochtaí Orlándaí Éireann, 2010.

© Sairbhéiríochtaí Orlándaí Éireann. Gach ceart ar chosaint. Uimhir cheadúnais 2010/18CCMA/Comhairle Contae na Gaillimhe.

Includes Ordnance Survey Ireland data reproduced under OSI Licence number 2010/18CCMA/Galway County Council. Unauthorised reproduction infringes Ordnance Survey Ireland and Government of Ireland copyright. © Ordnance Survey Ireland, 2010.

© Ordnance Survey Ireland. All rights reserved. Licence number 2010/18CCMA/Galway County Council.

Clients

Comhairle Chontae na Gaillimhe
Galway County Council

N6
Galway City Transport Project

An Roinn Iompair
Turasóireachta agus Spóirt

TIIP
Transport Infrastructure Ireland

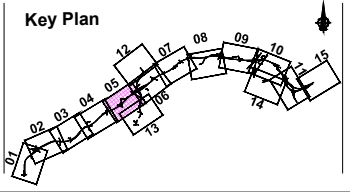

Consultant

ARUP

Corporate House
City East Business Park
Ballybrit, Galway, Ireland.

Tel +353 (0)91 460675
www.N6GalwayCity.ie
www.arup.ie

Job Title
N6 Galway City Ring Road

Scale
1:5000 @ A3

Date
September 2018

Issue	Date	By	Chkd	Appd
11	28/09/2018	KJ	MH	EMC

Drawing Title
Proposed Road Development Plan
CH.5+800 to CH.7+300
Sheet 5 of 15

Drawing Status
For Information

Job No
233985

Drawing No
Figure 5.1.05

Issue
11

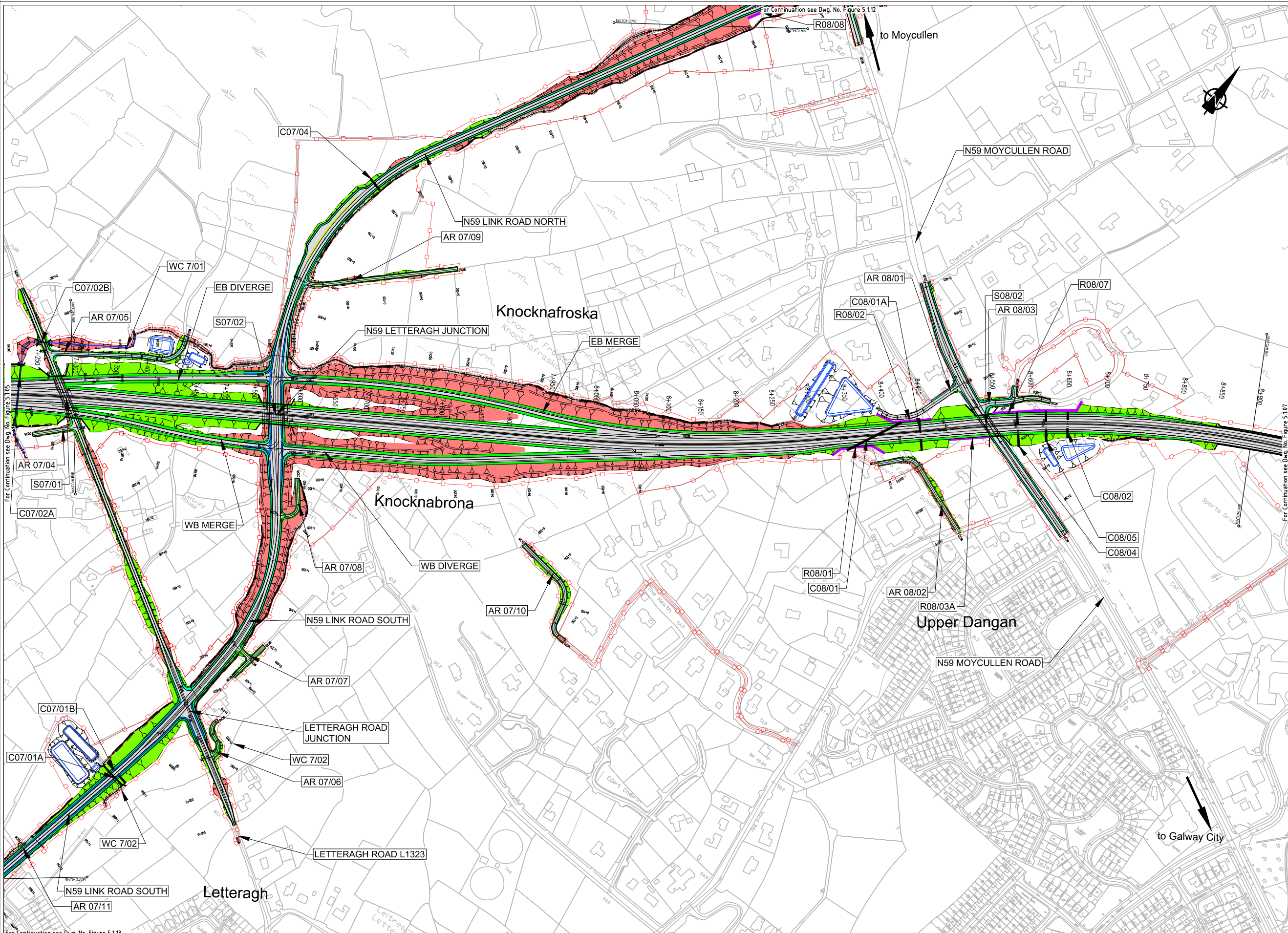

- Legend:**
- City Boundary
 - - - Proposed Development Boundary
 - ▬▬▬ Proposed Road Geometry
 - ▬▬▬ Earthworks - Fill
 - ▬▬▬ Earthworks - Cut
 - ▬▬▬ Proposed Carriageway Pavement
 - ▬▬▬ Proposed Grass Verge
 - ▬▬▬ Proposed Cycleway
 - ▬▬▬ Proposed Footpath
 - ▬▬▬ Proposed Shared Footpath/Cycleway
 - ▬▬▬ Proposed Traffic Island
 - ▬▬▬ Structure (S)
 - ▬▬▬ Proposed Retaining wall (R)
 - ▬▬▬ Proposed Mammal Underpass (C)
 - ▬▬▬ Proposed Culvert (C)
 - ▬▬▬ Proposed Attenuation Pond / Infiltration Basin / Wetlands
 - ▬▬▬ Proposed Stream Diversion
 - AR AR - Access Road
 - WC WC - Watercourse

San áiríúmh tá sonraíocht Shairbhíreachta Orlándaí Éireanní arna aistriú go dtailíocht físe Chéadainn OSI Uimh. 2010/18CCMA/Comhairle Contae na Gaillimhe. Sáráilom aistriú go dtailíocht na císcheart Shairbhíreachta Orlándaí Éireanní agus Rialtas na hÉireann. © Sairbhíreachta Orlándaí Éireann, 2010.

© Sairbhíreachta Orlándaí Éireann. Gach ceart ar chosaint. Uimhir cheadainn 2010/18CCMA/Comhairle Contae na Gaillimhe.

Includes Ordnance Survey Ireland data reproduced under OSI Licence number 2010/18CCMA/Galway County Council. Unauthorised reproduction infringes Ordnance Survey Ireland and Government of Ireland copyright. © Ordnance Survey Ireland, 2010.

© Ordnance Survey Ireland. All rights reserved. Licence number 2010/18CCMA/Galway County Council.

Clients

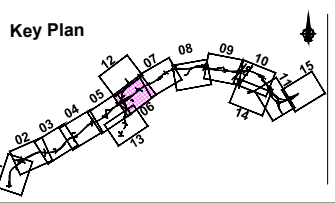

Consultant

Corporate House
City East Business Park
Ballybrit, Galway, Ireland.

Tel +353 (0)91 460675
www.N6GalwayCity.ie
www.arup.ie

Job Title
N6 Galway City Ring Road

Scale
1:5000 @ A3

Date
September 2018

Issue	Date	By	Chkd	Appd
11	28/09/2018	KJ	MH	EMC

Drawing Title
Proposed Road Development Plan
CH.7+300 to CH.8+900
Sheet 6 of 15

Drawing Status
For Information

Job No
233985

Drawing No
Figure 5.1.06

Issue
11

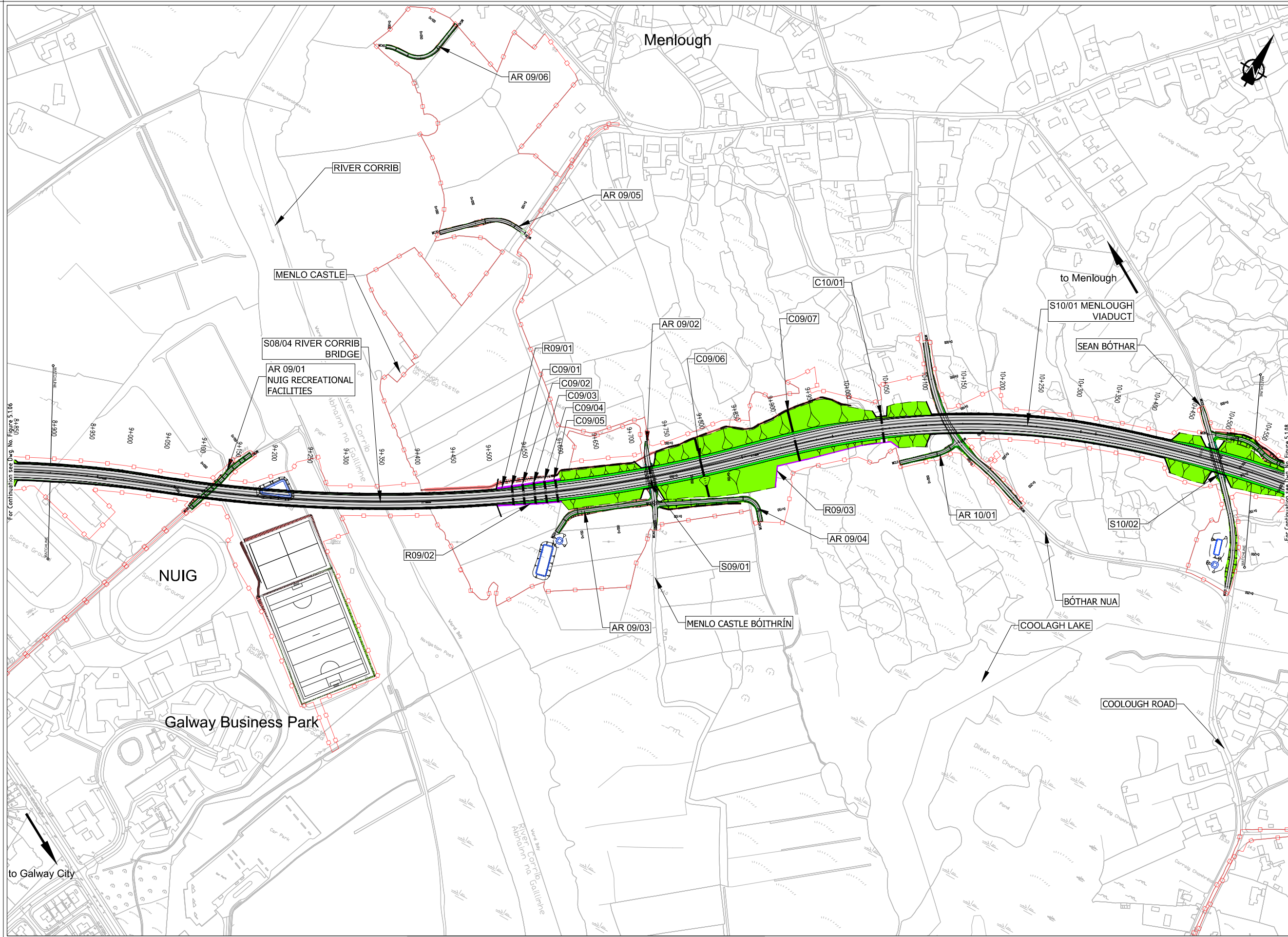

- Legend:**
- City Boundary
 - Proposed Development Boundary
 - Proposed Road Geometry
 - Earthworks - Fill
 - Earthworks - Cut
 - Proposed Carriageway Pavement
 - Proposed Grass Verge
 - Proposed Cycleway
 - Proposed Footpath
 - Proposed Shared Footpath/Cycleway
 - Proposed Traffic Island
 - Structure (S)
 - Proposed Retaining wall (R)
 - Proposed Mammal Underpass (C)
 - Proposed Culvert (C)
 - Proposed Attenuation Pond / Infiltration Basin / Wetlands
 - Proposed Stream Diversion
 - AR AR - Access Road
 - WC WC - Watercourse

For Continuation see Dwg. No. Figure 5.1.06

For Continuation see Dwg. No. Figure 5.1.08

Son áiríonn sé na sonraíochtaí Shuirbhíreacht Ordlánas Éireann arna aistriú go dtí físeán OSI Uimh. 2010/18CCMA/Comhairle Contae na Gaillimhe. Sárú ar na sonraíochtaí na mbíodáiríochtaí cóipeacht Shuirbhíreacht Ordlánas Éireann agus Rialtas na hÉireann. © Suirbhíreacht Ordlánas Éireann, 2010.

© Suirbhíreacht Ordlánas Éireann. Gach ceart ar chosaint. Uimhir cheadúnais 2010/18CCMA/Comhairle Contae na Gaillimhe.

Includes Ordnance Survey Ireland data reproduced under OSI Licence number 2010/18CCMA/Galway County Council. Unauthorised reproduction infringes Ordnance Survey Ireland and Government of Ireland copyright. © Ordnance Survey Ireland, 2010.

© Ordnance Survey Ireland. All rights reserved. Licence number 2010/18CCMA/Galway County Council.

Clients

Comhairle Chontae na Gaillimhe
Galway County Council

Galway City Transport Project

An Roinn Iompair
Turasóireachta agus Spóirt

TIIP
Bonneagair Tíomair Éireann

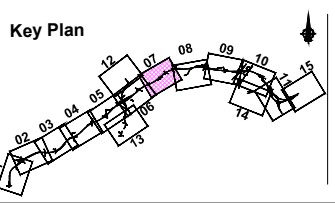

Consultant

ARUP

Corporate House
City East Business Park
Ballybrit, Galway, Ireland.

Tel +353 (0)91 460675
www.N6GalwayCity.ie
www.arup.ie

Job Title
N6 Galway City Ring Road

Scale
1:5000 @ A3

Date:
September 2018

Issue	Date	By	Chkd	Appd
11	28/09/2018	KJ	MH	EMC

Drawing Title
Proposed Road Development Plan
CH.8+900 to CH.10+550
Sheet 7 of 15

Drawing Status
For Information

Job No
233985

Drawing No
Figure 5.1.07

Issue
11

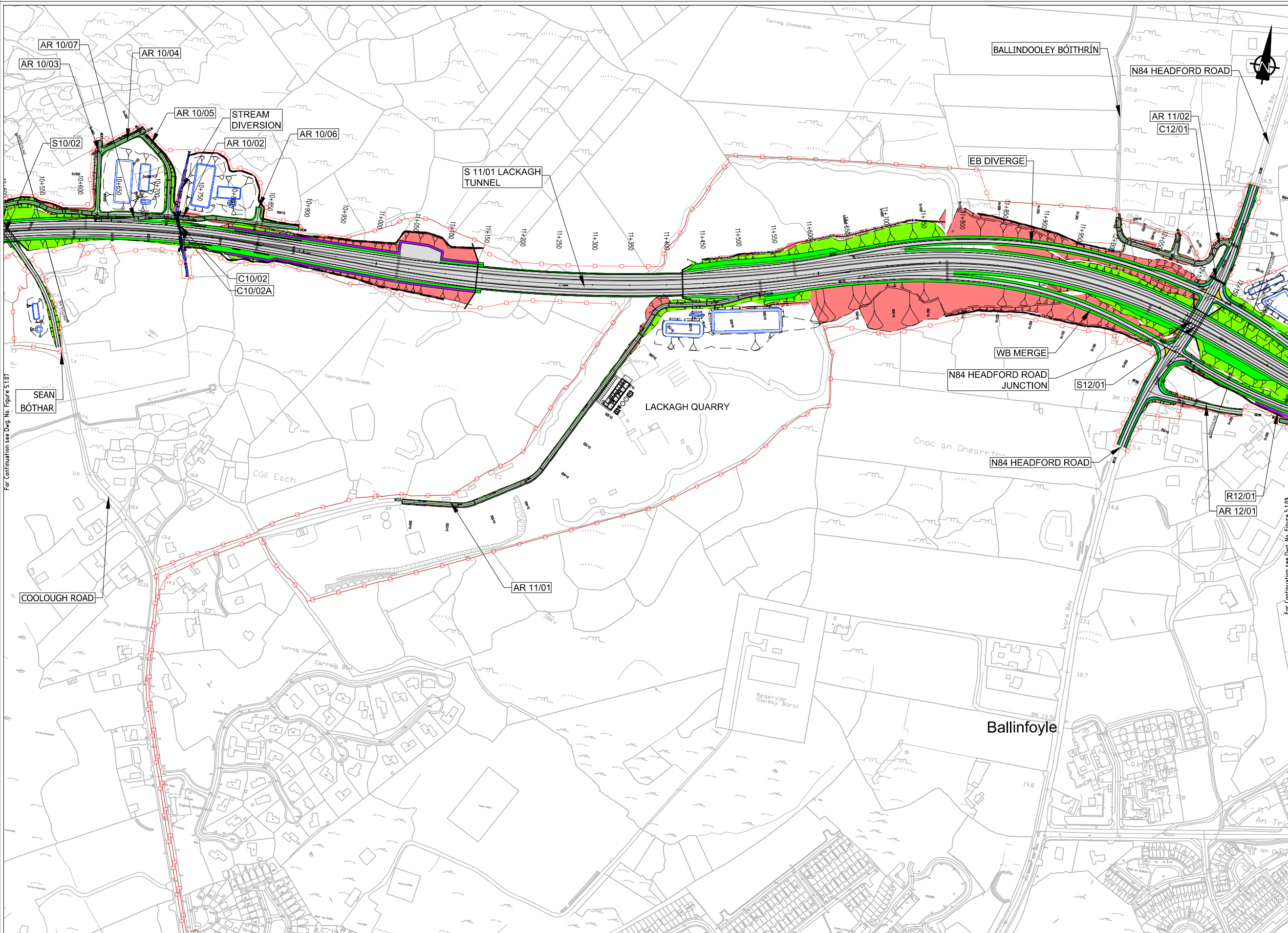

- Legend:**
- City Boundary
 - - - Proposed Development Boundary
 - ▬▬▬ Proposed Road Geometry
 - ▬▬▬ Earthworks - Fill
 - ▬▬▬ Earthworks - Cut
 - ▬▬▬ Proposed Carriageway Pavement
 - ▬▬▬ Proposed Grass Verge
 - ▬▬▬ Proposed Cycleway
 - ▬▬▬ Proposed Footpath
 - ▬▬▬ Proposed Shared Footpath/Cycleway
 - ▬▬▬ Proposed Traffic Island
 - ▬▬▬ Structure (S)
 - ▬▬▬ Proposed Retaining wall (R)
 - ▬▬▬ Proposed Mammal Underpass (C)
 - ▬▬▬ Proposed Culvert (C)
 - ▬▬▬ Proposed Attenuation Pond / Infiltration Basin / Wetlands
 - ▬▬▬ Proposed Stream Diversion
 - AR AR - Access Road
 - WC WC - Watercourse

For Continuation see Dwg. No. Figure 5.107

For Continuation see Dwg. No. Figure 5.109

Son áiríamh tá sonraíocht Shuirbhíreacht Orlándaís Éireann arna aistriú go dtailíú físe Chéadainn OSI Uimh. 2010/18CCMA/Comhairle Contae na Gaillimhe. Sáráilonn aistriú go dtailíú neamhdáraithe cóipeacht Shuirbhíreacht Orlándaís Éireann agus Rialtas na hÉireann. © Suirbhíreacht Orlándaís Éireann, 2010.

© Suirbhíreacht Orlándaís Éireann. Gach ceart ar chosaint. Uimhir cheadainn 2010/18CCMA/Comhairle Contae na Gaillimhe.

Includes Ordnance Survey Ireland data reproduced under OSI Licence number 2010/18CCMA/Galway County Council. Unauthorised reproduction infringes Ordnance Survey Ireland and Government of Ireland copyright. © Ordnance Survey Ireland, 2010.

© Ordnance Survey Ireland. All rights reserved. Licence number 2010/18CCMA/Galway County Council.

Clients

Comhairle Chontae na Gaillimhe
Galway County Council

Galway City Transport Project

An Roinn Iompair
Turasóireacht agus Spóirt
Department of Transport, Tourism and Sport

TII
Transport Infrastructure Ireland

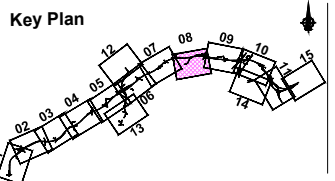

Consultant

ARUP

Corporate House
City East Business Park
Ballybrit, Galway, Ireland.

Tel +353 (0)91 460675
www.N6GalwayCity.ie
www.arup.ie

Job Title
N6 Galway City Ring Road

Scale
1:5000 @ A3

Date:
September 2018

Issue	Date	By	Chkd	Appd
11	28/09/2018	KJ	MH	EMC

Drawing Title
Proposed Road Development Plan
CH.10+550 to CH.12+200
Sheet 8 of 15

Drawing Status
For Information

Job No
233985

Drawing No
Figure 5.1.08

Issue
11

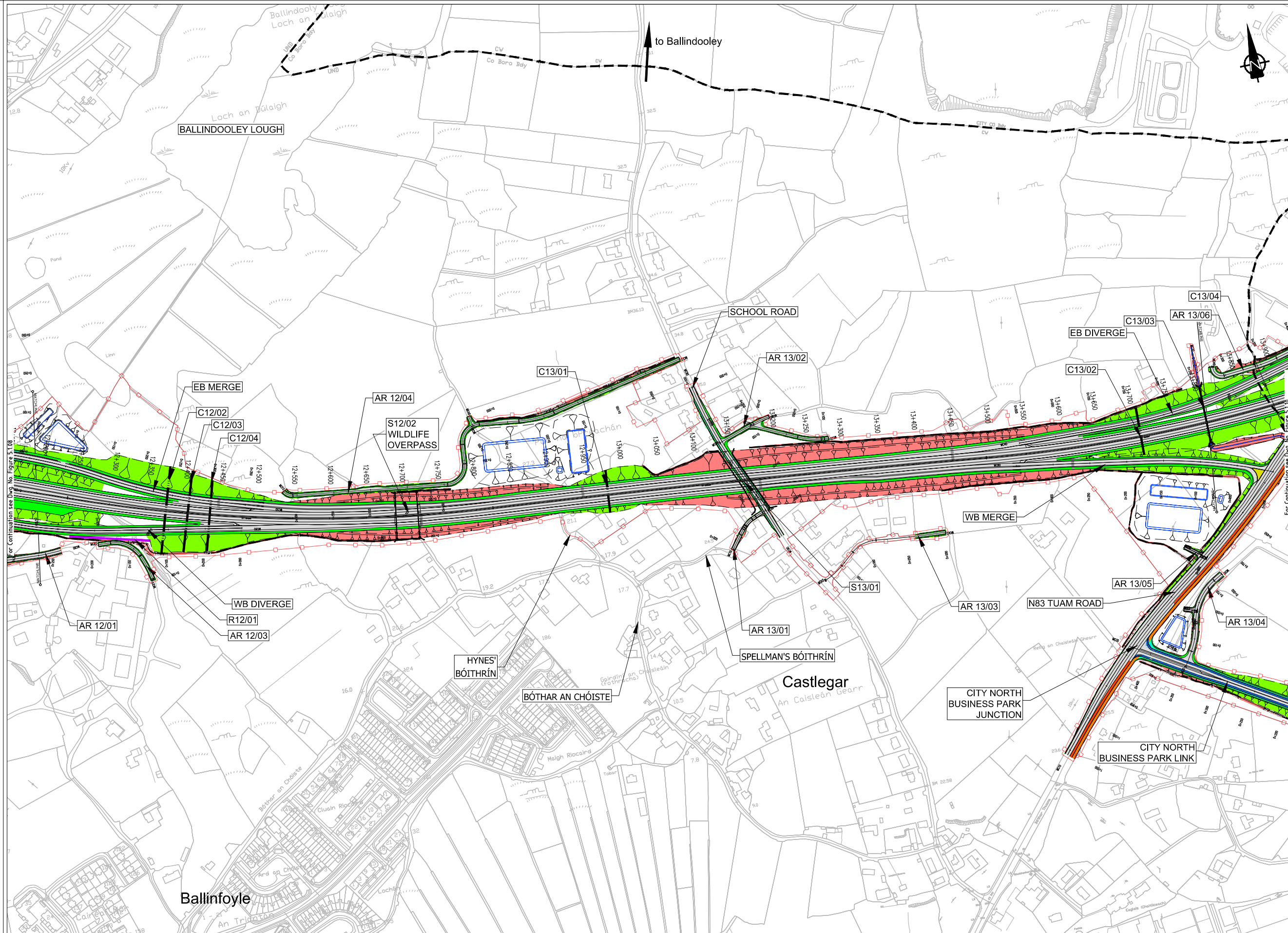

- Legend:**
- City Boundary
 - - - Proposed Development Boundary
 - ▬▬▬ Proposed Road Geometry
 - ▬▬▬ Earthworks - Fill
 - ▬▬▬ Earthworks - Cut
 - ▬▬▬ Proposed Carriageway Pavement
 - ▬▬▬ Proposed Grass Verge
 - ▬▬▬ Proposed Cycleway
 - ▬▬▬ Proposed Footpath
 - ▬▬▬ Proposed Shared Footpath/Cycleway
 - ▬▬▬ Proposed Traffic Island
 - ▬▬▬ Structure (S)
 - ▬▬▬ Proposed Retaining wall (R)
 - ▬▬▬ Proposed Mammal Underpass (C)
 - ▬▬▬ Proposed Culvert (C)
 - ▬▬▬ Proposed Attenuation Pond / Infiltration Basin / Wetlands
 - ▬▬▬ Proposed Stream Diversion
 - AR AR - Access Road
 - WC WC - Watercourse

Sun áiríomh tá sonraíocht Shairbhíreacht Orlándaí Éireann arna aistriú go dtí Ceardúnas OSI Uimh. 2010/18CCMA/Comhairle Contae na Gaillimhe. Sárúil ar aistriú go dtí na h-áiríomh na h-Éireann. © Sairbhíreacht Orlándaí Éireann, 2010.

© Sairbhíreacht Orlándaí Éireann. Gach ceart ar chosaint. Uimhir cheadúnais 2010/18CCMA/Comhairle Contae na Gaillimhe.

Includes Ordnance Survey Ireland data reproduced under OSI Licence number 2010/18CCMA/Galway County Council. Unauthorised reproduction infringes Ordnance Survey Ireland and Government of Ireland copyright. © Ordnance Survey Ireland, 2010.

© Ordnance Survey Ireland. All rights reserved. Licence number 2010/18CCMA/Galway County Council.

Clients

Comhairle Chontae na Gaillimhe
Galway County Council

Galway City Transport Project

An Roinn Iompair
Turasóireachta agus Spóirt

TIIP

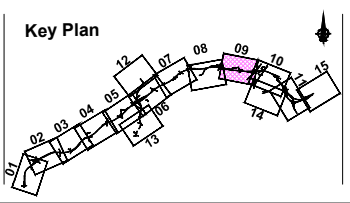

Consultant

ARUP

Corporate House
City East Business Park
Ballybrit, Galway, Ireland.

Tel +353 (0)91 460675
www.NEGalwayCity.ie
www.arup.ie

Job Title
N6 Galway City Ring Road

Scale
1:5000 @ A3

Date:
September 2018

Issue	Date	By	Chkd	Appd
11	28/09/2018	KJ	MH	EMC

Drawing Title
Proposed Road Development Plan
CH.12+200 to CH.13+800
Sheet 9 of 15

Drawing Status
For Information

Job No
233985

Drawing No
Figure 5.1.09

Issue
11

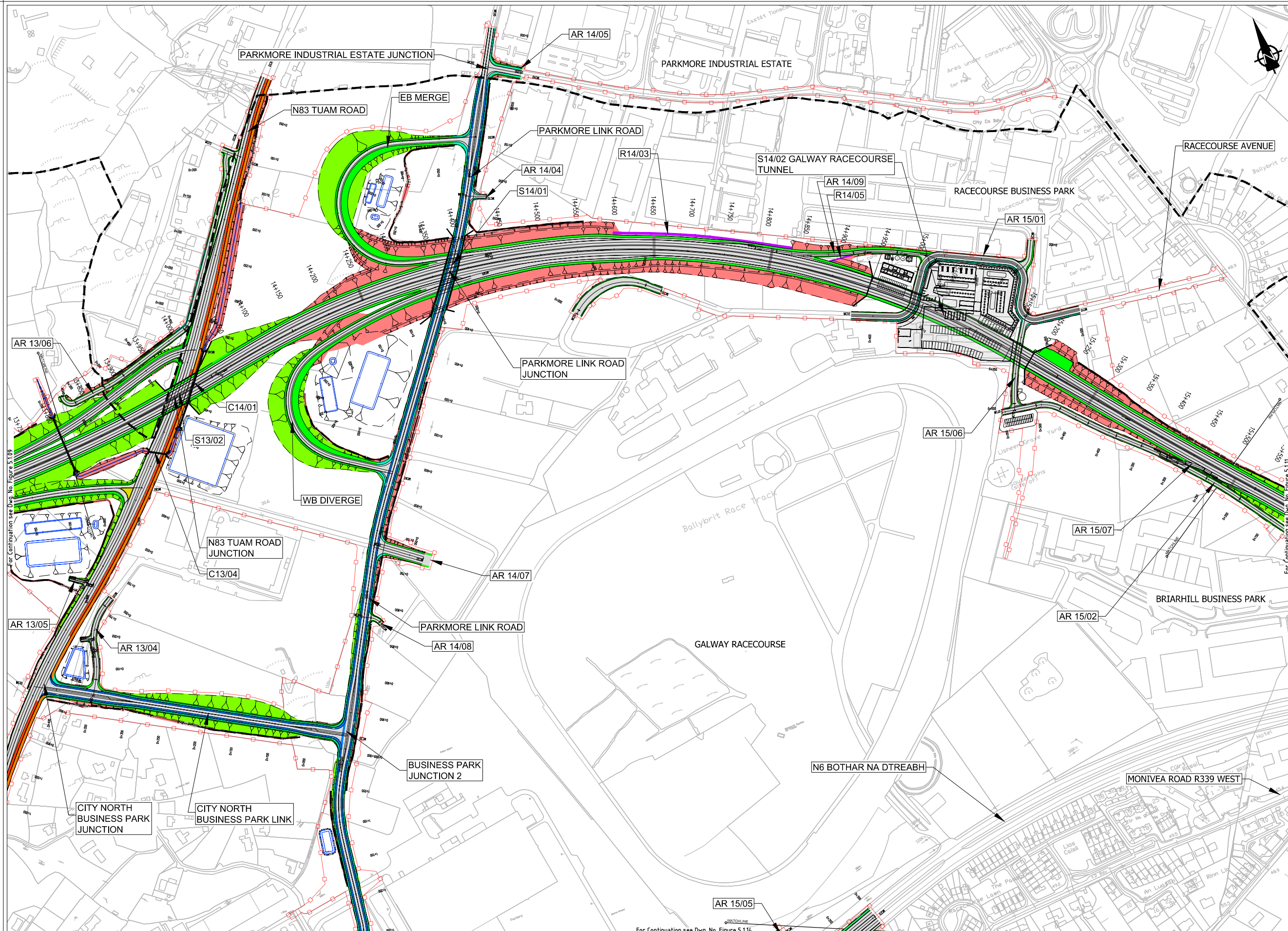

- Legend:**
- City Boundary
 - - - Proposed Development Boundary
 - ▬▬▬ Proposed Road Geometry
 - ▬▬▬ Earthworks - Fill
 - ▬▬▬ Earthworks - Cut
 - ▬▬▬ Proposed Carriageway Pavement
 - ▬▬▬ Proposed Grass Verge
 - ▬▬▬ Proposed Cycleway
 - ▬▬▬ Proposed Footpath
 - ▬▬▬ Proposed Shared Footpath/Cycleway
 - ▬▬▬ Proposed Traffic Island
 - ▬▬▬ Structure (S)
 - ▬▬▬ Proposed Retaining wall (R)
 - ▬▬▬ Proposed Mammal Underpass (C)
 - ▬▬▬ Proposed Culvert (C)
 - ▬▬▬ Proposed Attenuation Pond / Infiltration Basin / Wetlands
 - ▬▬▬ Proposed Stream Diversion
 - AR - Access Road
 - WC - Watercourse

Son áiríamh tá sonraíocht Shairbhíreacht Orlándaís Éireann arna aistriú go dtailíú físe Chéadúna OSi Uimh. 2010/18CCMA/Comhairle Contae na Gaillimhe. Sárúinn aistriú go dtailíú naimhárúnaíocht cóipeacht Shairbhíreacht Orlándaís Éireann agus Rialtas na hÉireann. © Sairbhíreacht Orlándaís Éireann, 2010.

© Sairbhíreacht Orlándaís Éireann. Gach ceart ar chosaint. Uimhir cheadúnaí 2010/18CCMA/Comhairle Contae na Gaillimhe.

Includes Ordnance Survey Ireland data reproduced under OSI Licence number 2010/18CCMA/Galway County Council. Unauthorised reproduction infringes Ordnance Survey Ireland and Government of Ireland copyright. © Ordnance Survey Ireland, 2010.

© Ordnance Survey Ireland. All rights reserved. Licence number 2010/18CCMA/Galway County Council.

Clients

Comhairle Contae na Gaillimhe
Galway County Council

N6
Galway City Transport Project

An Roinn Iompair
Turasóireacht agus Spóirt
Department of Transport, Tourism and Sport

TII
Transport Infrastructure Ireland

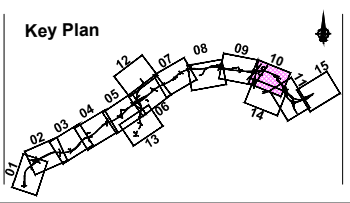

Consultant

ARUP

Corporate House
City East Business Park
Ballybrit, Galway, Ireland.

Tel +353 (0)91 460675
www.N6GalwayCity.ie
www.arup.ie

Job Title
N6 Galway City Ring Road

Scale
1:5000 @ A3

Date:
September 2018

Issue	Date	By	Chkd	Appd
11	28/09/2018	KJ	MH	EMC

Drawing Title
Proposed Road Development Plan
CH.13+800 to CH.15+500
Sheet 10 of 15

Drawing Status
For Information

Job No
233985

Drawing No
Figure 5.1.10

Issue
11

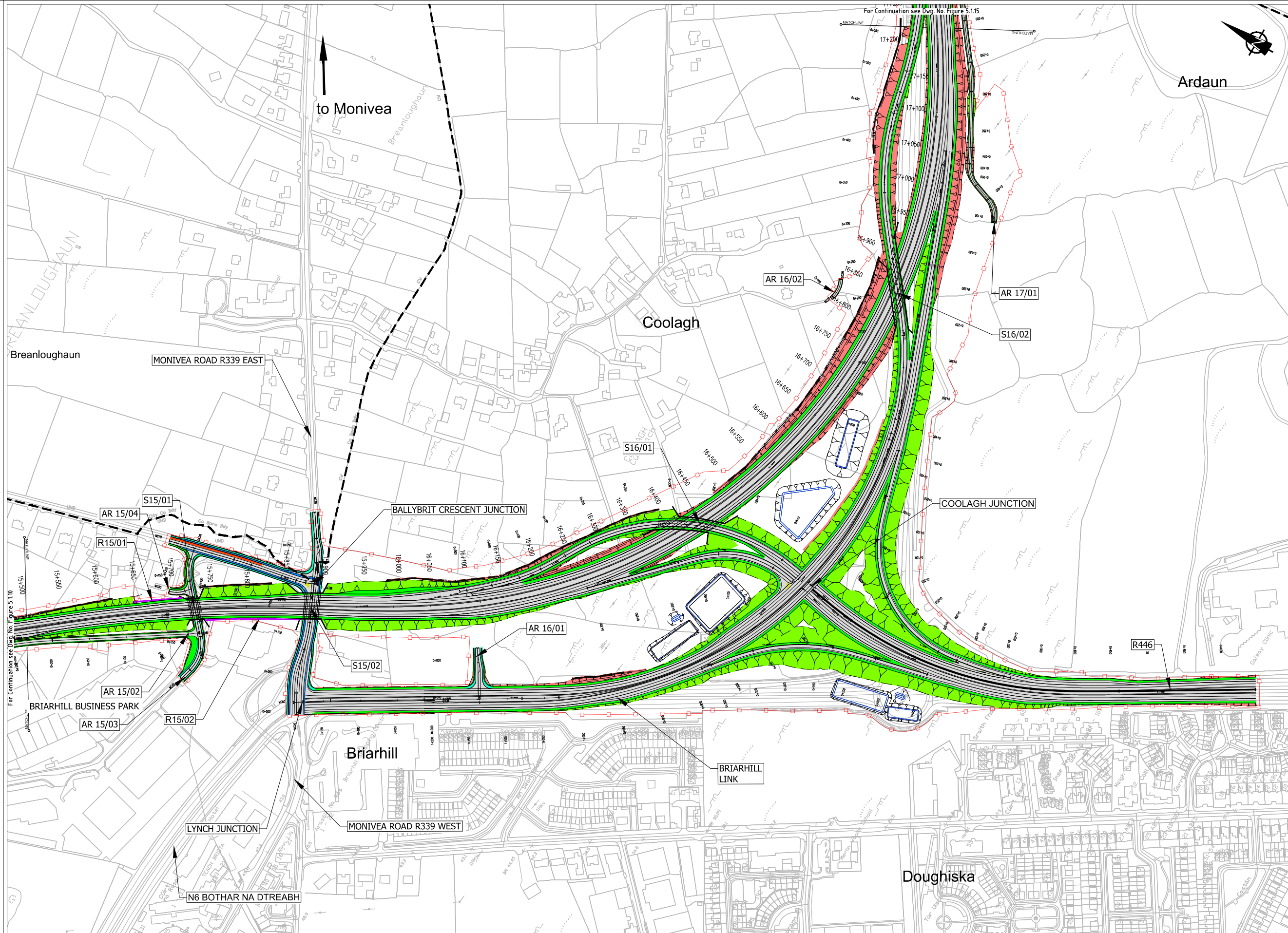

EIA REPORT

- Legend:**
- City Boundary
 - - - Proposed Development Boundary
 - ▬▬▬ Proposed Road Geometry
 - ▬▬▬ Earthworks - Fill
 - ▬▬▬ Earthworks - Cut
 - ▬▬▬ Proposed Carriageway Pavement
 - ▬▬▬ Proposed Grass Verge
 - ▬▬▬ Proposed Cycleway
 - ▬▬▬ Proposed Footpath
 - ▬▬▬ Proposed Shared Footpath/Cycleway
 - ▬▬▬ Proposed Traffic Island
 - ▬▬▬ Structure (S)
 - ▬▬▬ Proposed Retaining wall (R)
 - ▬▬▬ Proposed Mammal Underpass (C)
 - ▬▬▬ Proposed Culvert (C)
 - ▬▬▬ Proposed Attenuation Pond / Infiltration Basin / Wetlands
 - ▬▬▬ Proposed Stream Diversion
 - AR AR - Access Road
 - WC WC - Watercourse

Son áiríomh tá sonraíocht Shuirbhíreachta Orlándaís Éireann arna aistriú go dtailíú físe Chaidinéis OSI Uimh. 2010/18CCMA/Comhairle Contae na Gaillimhe. Sáráilom aistriú go dtailíú na n-áiríomh Shuirbhíreachta Orlándaís Éireann agus Rialtas na hÉireann. © Suirbhíreachta Orlándaís Éireann, 2010.

© Suirbhíreachta Orlándaís Éireann. Gach ceart ar chosaint. Uimhir cheadainis 2010/18CCMA/Comhairle Contae na Gaillimhe.

Includes Ordnance Survey Ireland data reproduced under OSI Licence number 2010/18CCMA/Galway County Council. Unauthorised reproduction infringes Ordnance Survey Ireland and Government of Ireland copyright. © Ordnance Survey Ireland, 2010.

© Ordnance Survey Ireland. All rights reserved. Licence number 2010/18CCMA/Galway County Council.

Clients

Comhairle Chontae na Gaillimhe
Galway County Council

N6
Galway City Transport Project

An Roinn Iompair
Turasóireachta agus Spóirt

TIIP
Bonnagarth Taispeán Éireann

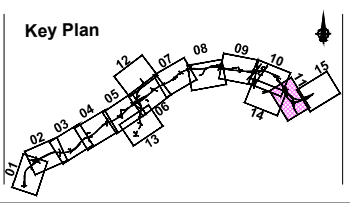

Consultant

ARUP

Corporate House
City East Business Park
Ballybrit, Galway, Ireland.

Tel +353 (0)91 460675
www.N6GalwayCity.ie
www.arup.ie

Job Title
N6 Galway City Ring Road

Scale
1:5000 @ A3

Date:
September 2018

Drawing Title				
Proposed Road Development Plan CH.15+500 to CH.17+200 Sheet 11 of 15				
Drawing Status				
For Information				
Job No	Drawing No	Issue	Date	By
233985	Figure 5.1.11	11	28/09/2018	KJ
Issue	Date	By	Chkd	Appd
11	28/09/2018	KJ	MH	EMC

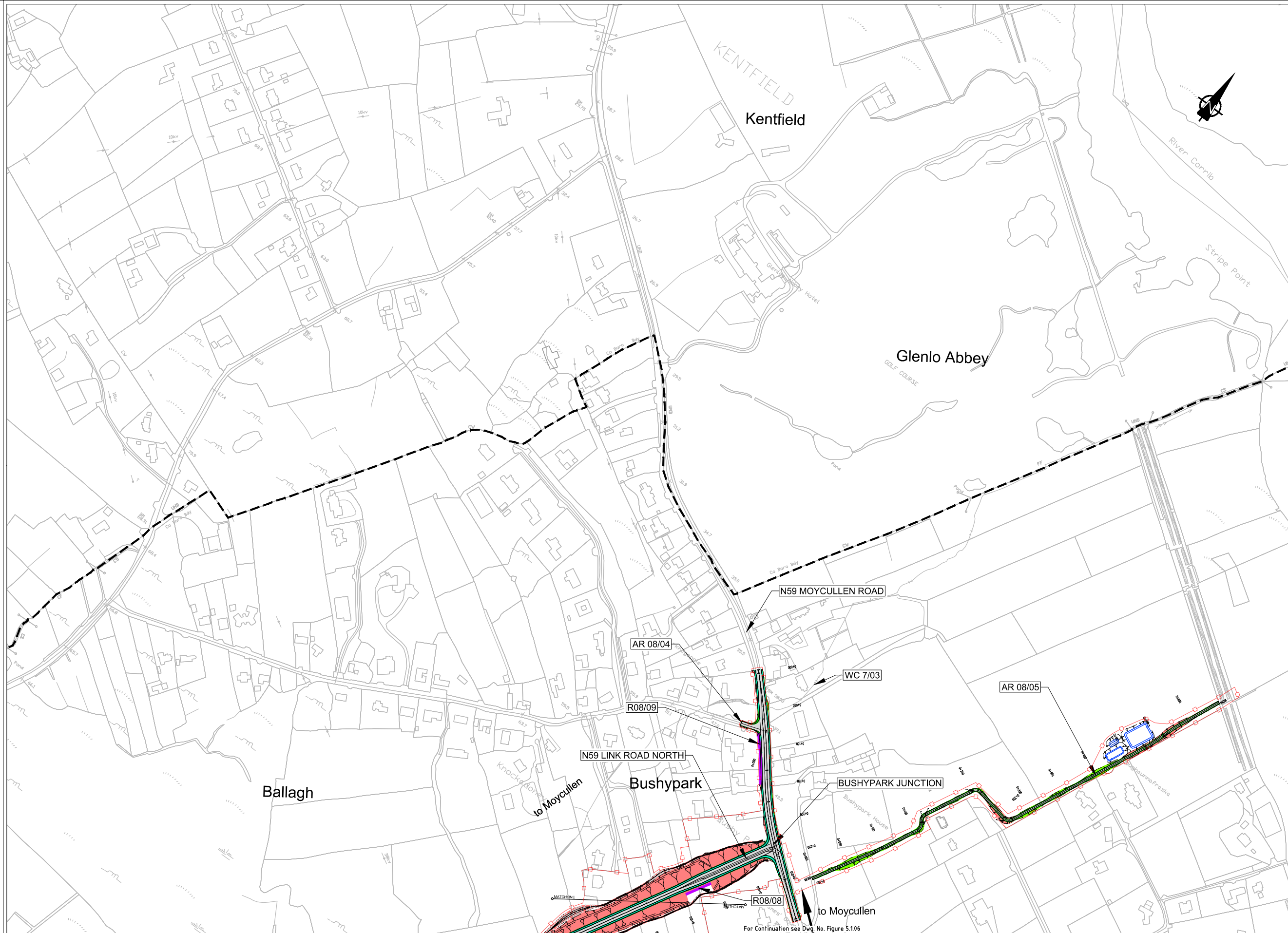

- Legend:**
- City Boundary
 - Proposed Development Boundary
 - Proposed Road Geometry
 - Earthworks - Fill
 - Earthworks - Cut
 - Proposed Carriageway Pavement
 - Proposed Grass Verge
 - Proposed Cycleway
 - Proposed Footpath
 - Proposed Shared Footpath/Cycleway
 - Proposed Traffic Island
 - Structure (S)
 - Proposed Retaining wall (R)
 - Proposed Mammal Underpass (C)
 - Proposed Culvert (C)
 - Proposed Attenuation Pond / Infiltration Basin / Wetlands
 - Proposed Stream Diversion
 - AR - Access Road
 - WC - Watercourse

Son áiríamh tá sonraíocht Shairbhíreacht Orlándaís Éireann arna aistriú go dtí físeán OSI Uimh. 2010/18CCMA/Comhairle Contae na Gaillimhe. Sáráilom aistriú go dtí neamháráilthe cóipeacht Shairbhíreacht Orlándaís Éireann agus Rialtas na hÉireann. © Sairbhíreacht Orlándaís Éireann, 2010.

© Sairbhíreacht Orlándaís Éireann. Gach ceart ar chosaint. Uimhir cheadúnais 2010/18CCMA/Comhairle Contae na Gaillimhe.

Includes Ordnance Survey Ireland data reproduced under OSI Licence number 2010/18CCMA/Galway County Council. Unauthorised reproduction infringes Ordnance Survey Ireland and Government of Ireland copyright. © Ordnance Survey Ireland, 2010.

© Ordnance Survey Ireland. All rights reserved. Licence number 2010/18CCMA/Galway County Council.

Clients

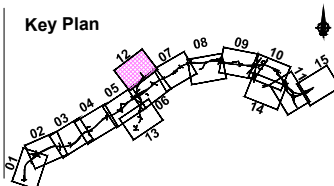

Consultant

Corporate House
City East Business Park
Ballybrit, Galway, Ireland.

Tel +353 (0)91 460675
www.N6GalwayCity.ie
www.arup.ie

Job Title
N6 Galway City Ring Road

Scale
1:5000 @ A3

Date:
September 2018

Issue	Date	By	Chkd	Appd
11	28/09/2018	KJ	MH	EMC

Drawing Title
**Proposed Road Development Plan
N59 Link Road North
Sheet 12 of 15**

Drawing Status
For Information

Job No 233985	Drawing No Figure 5.1.12	Issue 11
-------------------------	------------------------------------	--------------------

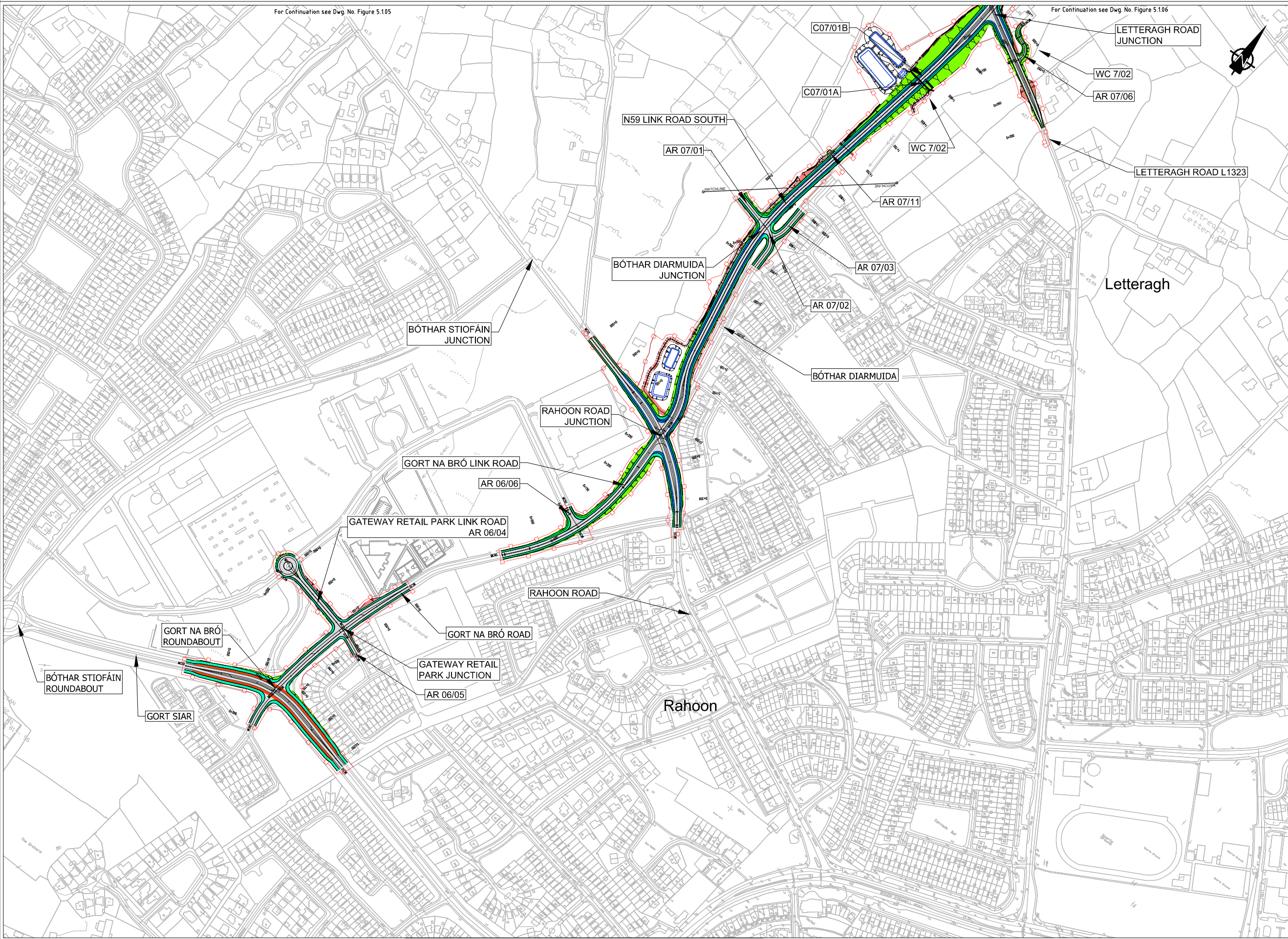

- Legend:**
- City Boundary
 - - - Proposed Development Boundary
 - ▬▬▬ Proposed Road Geometry
 - ▬▬▬ Earthworks - Fill
 - ▬▬▬ Earthworks - Cut
 - ▬▬▬ Proposed Carriageway Pavement
 - ▬▬▬ Proposed Grass Verge
 - ▬▬▬ Proposed Cycleway
 - ▬▬▬ Proposed Footpath
 - ▬▬▬ Proposed Shared Footpath/Cycleway
 - ▬▬▬ Proposed Traffic Island
 - ▬▬▬ Structure (S)
 - ▬▬▬ Proposed Retaining wall (R)
 - ▬▬▬ Proposed Mammal Underpass (C)
 - ▬▬▬ Proposed Culvert (C)
 - ▬▬▬ Proposed Attenuation Pond / Infiltration Basin / Wetlands
 - ▬▬▬ Proposed Stream Diversion
 - AR AR - Access Road
 - WC WC - Watercourse

Son áiríamh tá sonraíocht Shairbhéireacht Ordnáis Éireann arna aistriú go dtí físeán OSI Uimh. 2010/18CCMA/Comhairle Contae na Gaillimhe. Sáráilom aistriú go dtí neamháráilte cóipeacht Shairbhéireacht Ordnáis Éireann agus Rialtas na hÉireann. © Sairbhéireacht Ordnáis Éireann, 2010.

© Sairbhéireacht Ordnáis Éireann. Gach ceart ar chosaint. Uimhir cheadainis 2010/18CCMA/Comhairle Contae na Gaillimhe.

Includes Ordnance Survey Ireland data reproduced under OSI Licence number 2010/18CCMA/Galway County Council. Unauthorised reproduction infringes Ordnance Survey Ireland and Government of Ireland copyright. © Ordnance Survey Ireland, 2010.

© Ordnance Survey Ireland. All rights reserved. Licence number 2010/18CCMA/Galway County Council.

Clients

Comhairle Contae na Gaillimhe
Galway County Council

Galway City Transport Project

An Roinn Iompair
Turasóireachta agus Spóirt

TIIP

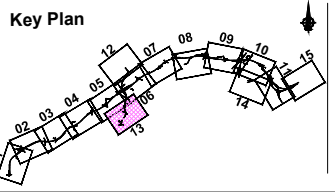

Consultant

ARUP

Corporate House
City East Business Park
Ballybrit, Galway, Ireland.

Tel +353 (0)91 460675
www.N6GalwayCity.ie
www.arup.ie

Job Title
N6 Galway City Ring Road

Scale
1:5000 @ A3

Date:
September 2018

Issue	Date	By	Chkd	Appd
11	28/09/2018	KJ	MH	EMC

Drawing Title
Proposed Road Development Plan
N59 Link Road South, Gateway Retail Park Junction
Sheet 13 of 15

Drawing Status
For Information

Job No
233985

Drawing No
Figure 5.1.13

Issue
11



EIA REPORT

- Legend:**
- City Boundary
 - - - - - Proposed Development Boundary
 - ▬▬▬▬▬▬ Proposed Road Geometry
 - ▬▬▬▬▬▬ Earthworks - Fill
 - ▬▬▬▬▬▬ Earthworks - Cut
 - ▬▬▬▬▬▬ Proposed Carriageway Pavement
 - ▬▬▬▬▬▬ Proposed Grass Verge
 - ▬▬▬▬▬▬ Proposed Cycleway
 - ▬▬▬▬▬▬ Proposed Footpath
 - ▬▬▬▬▬▬ Proposed Shared Footpath/Cycleway
 - ▬▬▬▬▬▬ Proposed Traffic Island
 - ▬▬▬▬▬▬ Structure (S)
 - ▬▬▬▬▬▬ Proposed Retaining wall (R)
 - ▬▬▬▬▬▬ Proposed Mammal Underpass (C)
 - ▬▬▬▬▬▬ Proposed Culvert (C)
 - ▬▬▬▬▬▬ Proposed Attenuation Pond / Infiltration Basin / Wetlands
 - ▬▬▬▬▬▬ Proposed Stream Diversion
 - AR AR - Access Road
 - WC WC - Watercourse

San áiríúmh tá sonraíocht Shairbhéireacht Orlándaís Éireann arna aistriú go dtí físeán Ceardúnas OSI Uimh. 2010/18CCMA/Comhairle Contae na Gaillimhe. Sáráilom aistriú go dtí na neamháráilthe cóipeacht Shairbhéireacht Orlándaís Éireann agus Rialtas na hÉireann. © Sairbhéireacht Orlándaís Éireann, 2010.

© Sairbhéireacht Orlándaís Éireann. Gach ceart ar chosaint.
Uimhir cheadúnais 2010/18CCMA/Comhairle Contae na Gaillimhe.

Includes Ordnance Survey Ireland data reproduced under OSI Licence number 2010/18CCMA/Galway County Council.
Unauthorised reproduction infringes Ordnance Survey Ireland and Government of Ireland copyright. © Ordnance Survey Ireland, 2010.

© Ordnance Survey Ireland. All rights reserved. Licence number 2010/18CCMA/Galway County Council.

Clients

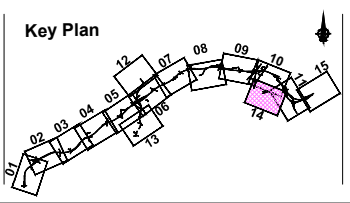

Consultant

Corporate House
City East Business Park
Ballybrit, Galway, Ireland.

Tel +353 (0)91 460675
www.NGalwayCity.ie
www.arup.ie

Job Title
N6 Galway City Ring Road

Scale
1:5000 @ A3

Date:
September 2018

Issue	Date	By	Chkd	Appd
11	28/09/2018	KJ	MH	EMC

Drawing Title
Proposed Road Development Plan
City East Junction
Sheet 14 of 15

Drawing Status
For Information

Job No 233985	Drawing No Figure 5.1.14	Issue 11
-------------------------	------------------------------------	--------------------

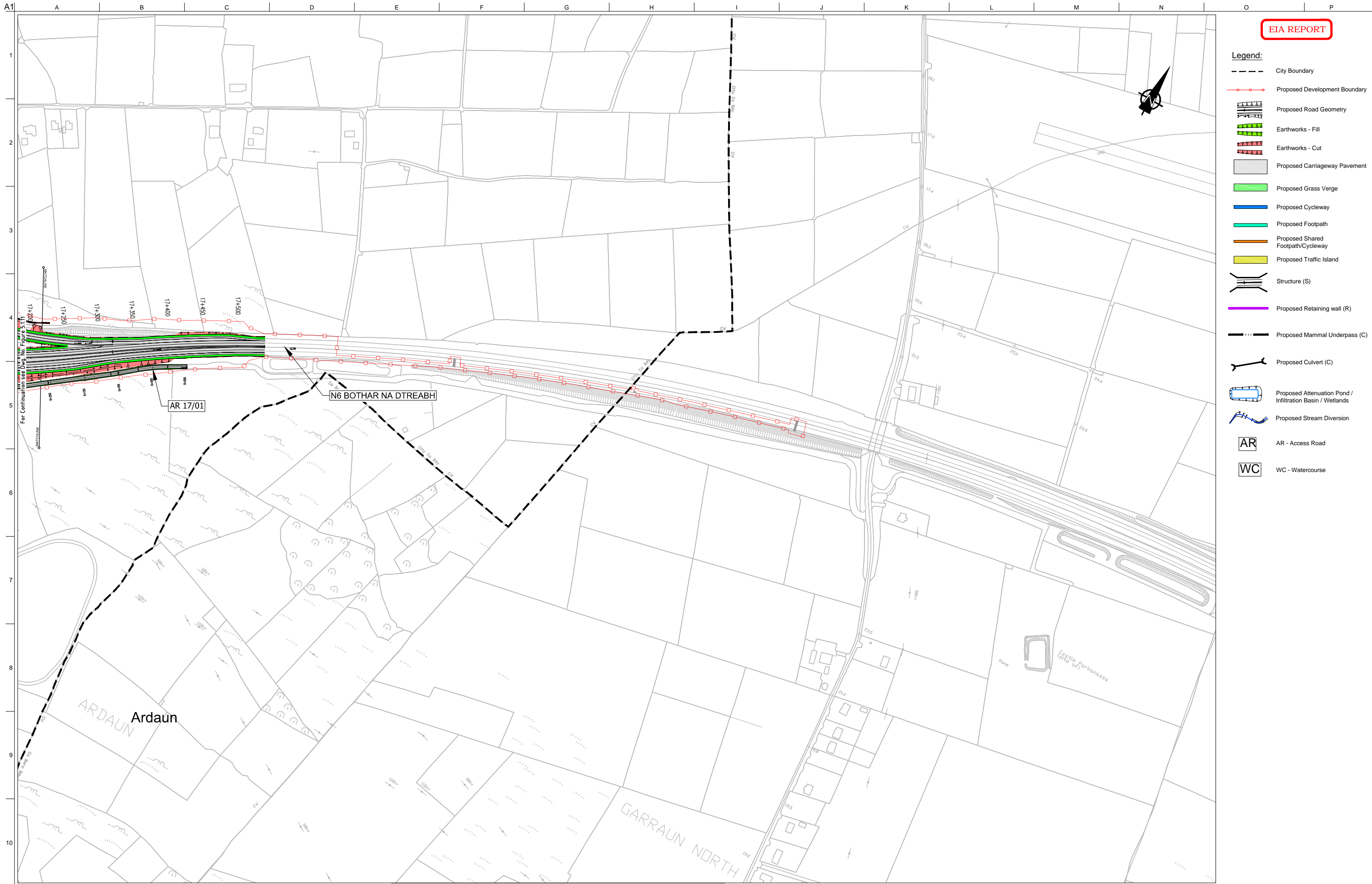

EIA REPORT

- Legend:**
- City Boundary
 - - - - - Proposed Development Boundary
 - ▬▬▬▬▬▬ Proposed Road Geometry
 - ▬▬▬▬▬▬ Earthworks - Fill
 - ▬▬▬▬▬▬ Earthworks - Cut
 - ▬▬▬▬▬▬ Proposed Carriageway Pavement
 - ▬▬▬▬▬▬ Proposed Grass Verge
 - ▬▬▬▬▬▬ Proposed Cycleway
 - ▬▬▬▬▬▬ Proposed Footpath
 - ▬▬▬▬▬▬ Proposed Shared Footpath/Cycleway
 - ▬▬▬▬▬▬ Proposed Traffic Island
 - ▬▬▬▬▬▬ Structure (S)
 - ▬▬▬▬▬▬ Proposed Retaining wall (R)
 - ▬▬▬▬▬▬ Proposed Mammal Underpass (C)
 - ▬▬▬▬▬▬ Proposed Culvert (C)
 - ▬▬▬▬▬▬ Proposed Attenuation Pond / Infiltration Basin / Wetlands
 - ▬▬▬▬▬▬ Proposed Stream Diversion
 - AR AR - Access Road
 - WC WC - Watercourse

San áiríúmh tá sonraíocht Shuirbhíreachtú Ordnáis Éireann arna aistriú go dtailíú fíúí Cheadúnas OSI Uimh. 2010/18CCMA/Comhairle Contae na Gaillimhe. Sáráilom aistriú go dtailíú neamhdáraithe cóipeacht Shuirbhíreachtú Ordnáis Éireann agus Rialtas na hÉireann. © Suirbhíreachtú Ordnáis Éireann, 2010.

© Suirbhíreachtú Ordnáis Éireann. Gach ceart ar chosaint. Uimhir cheadúnais 2010/18CCMA/Comhairle Contae na Gaillimhe.

Includes Ordnance Survey Ireland data reproduced under OSI Licence number 2010/18CCMA/Galway County Council. Unauthorised reproduction infringes Ordnance Survey Ireland and Government of Ireland copyright. © Ordnance Survey Ireland, 2010.

© Ordnance Survey Ireland. All rights reserved. Licence number 2010/18CCMA/Galway County Council.

Clients

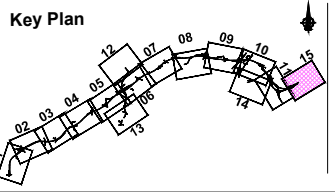

Consultant

Corporate House
City East Business Park
Ballybrit, Galway, Ireland.

Tel +353 (0)91 460675
www.N6GalwayCity.ie
www.arup.ie

Job Title
N6 Galway City Ring Road

Scale
1:5000 @ A3

Date:
September 2018

Issue	Date	By	Chkd	Appd
11	28/09/2018	KJ	MH	EMC

Drawing Title
Proposed Road Development Plan
CH.17+200 to (End of Scheme-Existing N6-CH.18+550)
Sheet 15 of 15

Drawing Status
For Information

Job No	Drawing No	Issue
233985	Figure 5.1.15	11